



MUCLPPL 200
MUCLPPL 200

STAINLESS STEEL BEARING INSERT

TECHNICAL DATA

No corrosion

FDA&FSDA approval

From 12 to 17 mm

Interchangeable with cast iron standards units

Maintenance free

Temperature work from - 35 to 102 degree

Tensile strength at break (ASTM 0630) is an impressive 17.300 PSI

Excellent mechanical strength' stiffness & dimension stability

Stainless Steel greasers and inserts

Solid base prevent dirt & bacteria

Reluable



OPTIONS

Close covers

Open covers (with Stainless Steel spring)

Back seals

Plastic covers for grease nipple

Color

BEARINGS INSERT

Stainless Steel type MUC

Stainless Steel type MB

Steel UC

Steel B

Steel Eccentric UG

Steel UK

MATERIAL

Housing

Exclusive PBT

Stainless Steel 304 inserts

Stainless Steel 304 greaser

Cover

Polypropylen

Stainless Steel ring

THERMOPLASTIC HOUSED LIGHT PILLOW BLOCKS

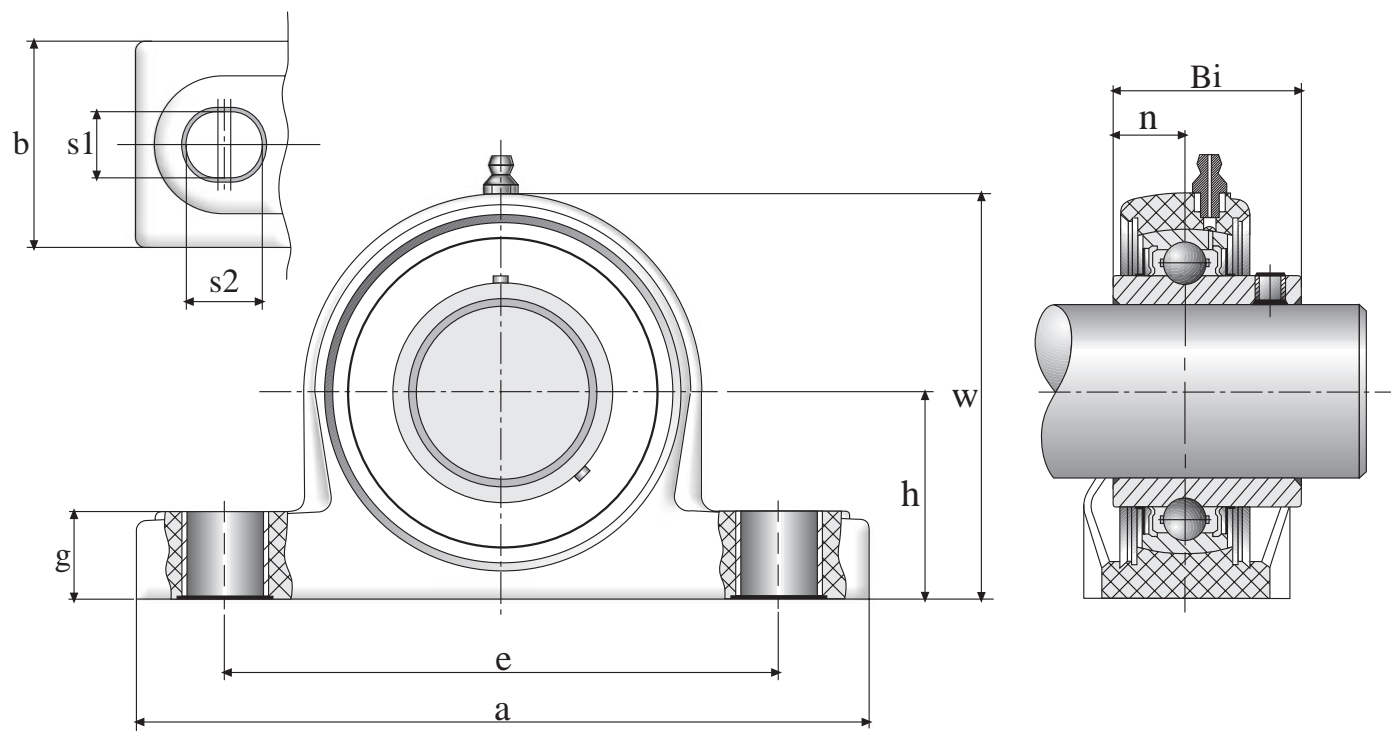

UNIT NUMBER	SHAFT DIAMETER		DIMENSIONS (mm)										WEIGHT (kg)	max. TORQUE		HOUSING NUMBER	BEARING NUMBER
	mm	inch	h	a	e	b	S1	S2	g	w	Bi	n		bolt d.	Nm		
MUCLPPL-201	12	1/2	30.2	114	87	25	11	14	14.2	57	26	10	0.24	M10	16	L-PPL-203	UCW-201
MUCLPPL-202	15	9/16, 5/8	30.2	114	87	25	11	14	14.2	57	26	10	0.23	M10	16	L-PPL-203	UCW-202
MUCLPPL-203	17	1 1/16	30.2	114	87	25	11	14	14.2	57	26	10	0.22	M10	16	L-PPL-203	UCW-203

MODE OF LOAD	BREAKING POINT TEST	
	201-203	
	8100	
	7200	
	4800	