



UCPA 200  
UCPA 200

STEEL BEARING INSERT



## BEARINGS INSERT

**Steel UC**

**Steel Eccentric UG**

**Steel UK**

**Special heat-treatment on  
bearing inner ring**

**Unique device to prevent  
bearing outer ring rotation**

## MATERIAL

**Efficient sealing**

**The self-contained bearing is  
double sealed with a combination  
of heat-resistant oil-proof  
synthetic rubber seal and steel  
slinger**

## TECHNICAL DATA

**Rational self-alignment**

**Larger load carrying capacity**

**Quiet operation**

**Longer service life**

**ANB Bearing Units with cast  
iron and rubber housings are  
all relubricable type equipped  
with grease fittings to secure  
full performance and longer  
service life of the units under  
any operating condition**

**Solid housing**

**The cast iron housing is of solid  
one-piece construction to  
provide maximum rigidity  
against deformation at  
mounting and wear resistance  
for any operating condition.**

**Easy and positive locking to  
shaft.**

**Complete interchangeability  
between bearing and housing.**

**Easy installation**

**The self-contained bearing is  
prelubricated with an adequate  
quantity of high quality grease**

CAST IRON TOP BASED

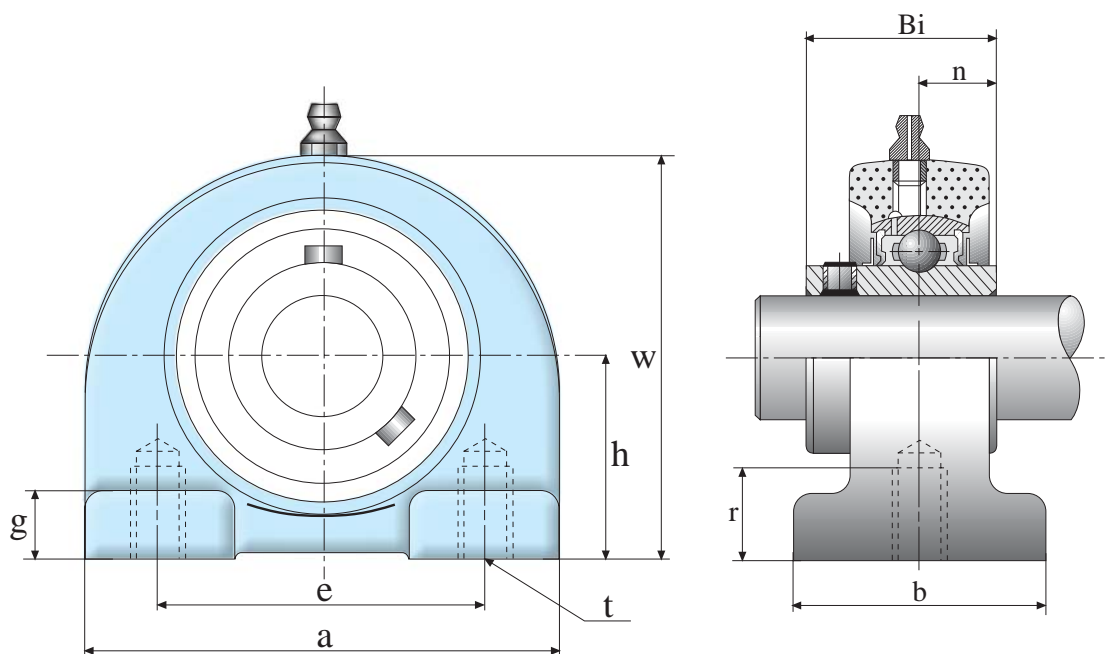

UNIT NUMBER	SHAFT DIAM.	DIMENSIONS (mm)									WEIGHT (kg)	BOLT SIZE	BEARING NUMBER	HOUSING NUMBER
	mm	h	a	e	b	r	g	w	Bi	n		mm		
UCPA201	12	30.2	76	52	38	12	8	62	31	12.7	0.65	M10	UC201	PA204
UCPA202	15	30.2	76	52	38	12	8	62	31	12.7	0.63	M10	UC202	PA204
UCPA203	17	30.2	76	52	38	12	8	62	31	12.7	0.62	M10	UC203	PA204
UCPA204	20	30.2	76	52	38	12	8	62	31	12.7	0.60	M10	UC204	PA204
UCPA205	25	36.5	84	56	38	15	10	72	34.1	14.3	0.81	M10	UC205	PA205
UCPA206	30	42.9	94	66	48	18	10	84	38.1	15.9	1.2	M14	UC206	PA206
UCPA207	35	47.6	110	80	48	20	12	95	42.9	17.5	1.7	M14	UC207	PA207
UCPA208	40	49.2	116	84	54	20	12	100	49.2	19	1.9	M14	UC208	PA208
UCPA209	45	54.2	120	90	54	25	12	108	49.2	19	2.2	M14	UC209	PA209
UCPA210	50	57.2	130	94	60	25	14	116	51.6	19	2.6	M16	UC210	PA210